

**INSTRUCTIONS:**

1. REMOVE AND DISCARD THE 4 M8 BOLTS AND THE TURN SIGNAL BRACKET BOLTS.
2. INSTALL THE LEFT AND RIGHT FRAME USING THE M8 SUPPLIED BOLTS. NOTE THE ORIENTATION. THE LEFT AND RIGHT SIDES ARE THE SAME PART. LEAVE EVERYTHING AS LOOSE AS POSSIBLE. USE THREADLOCKER ON ALL HARDWARE.
3. PRESS THE HOOP IN BETWEEN THE LEFT AND RIGHT FRAMES. YOU MAY NEED TO TAP IN INTO PLACE, IT CAN BE TIGHT.
4. LOOSELY INSTALL THE 4 SOCKET HEAD CAP SCREWS.
5. DO NOT USE POWER TOOLS - ONLY USE A HAND TOOL TO TIGHTEN ALL HARDWARE. DO NOT EXCEED HONDA TORQUE SPECS.
6. TIGHTEN EVERYTHING UP. START BY TIGHTENING THE 4 SOCKET HEAD CAP SCREWS.
7. THE LEFT AND RIGHT FRAMES MAY DEFLECT A BIT AS THE BOLTS ARE TORQUED.

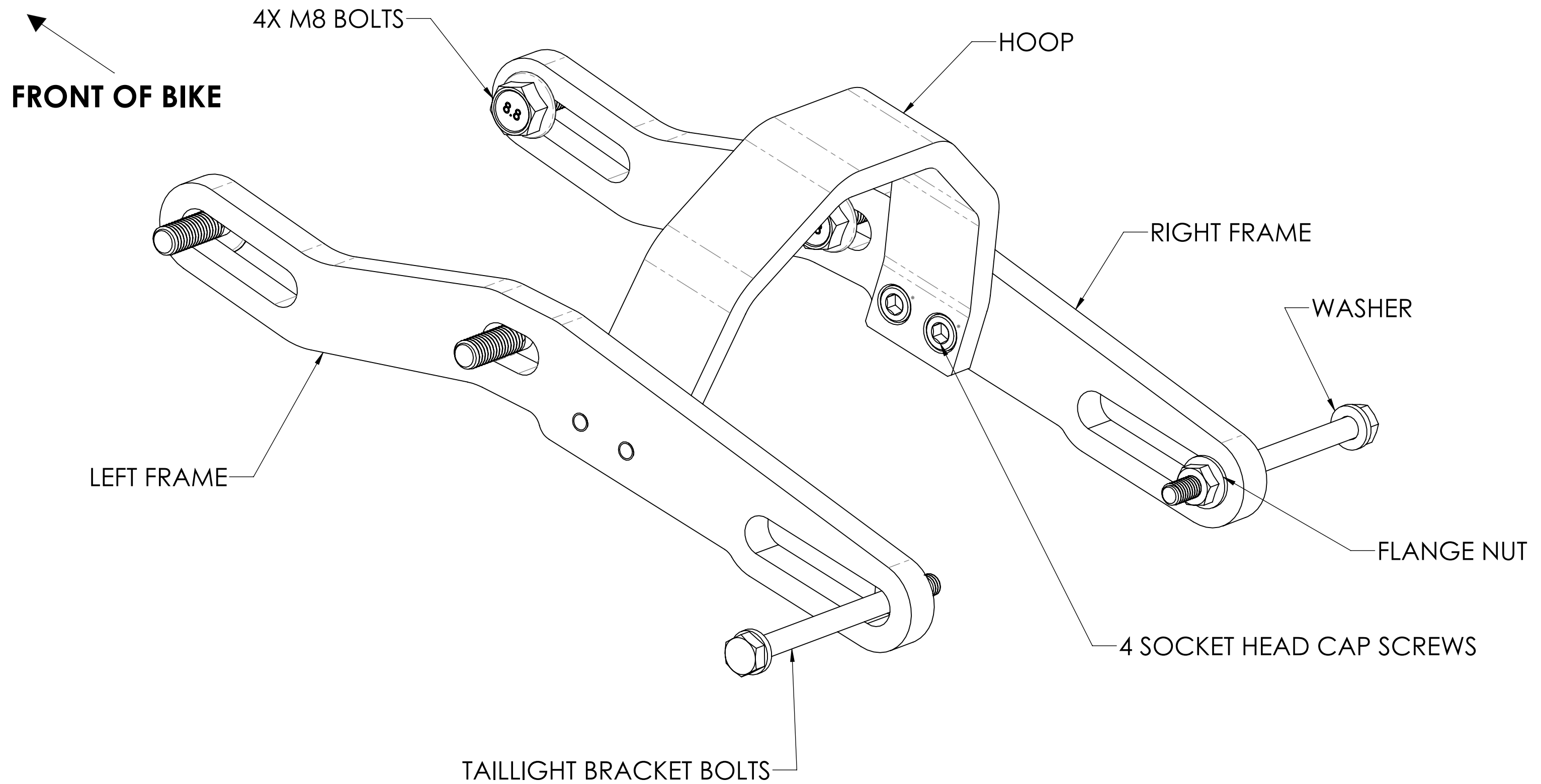

# XR650L REAR SUBFRAME SUPPORT